

SERIE TUBI
TUBE SERIES

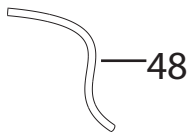

SERIE TUBI CON BOCCOLE
TUBE SERIES WITH BUSHES

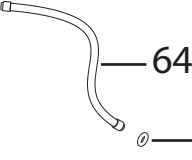

72

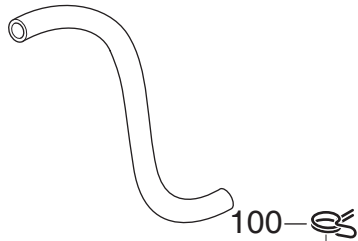
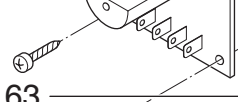
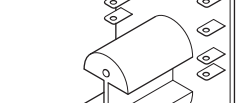
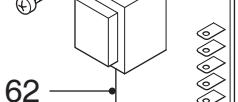
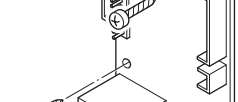
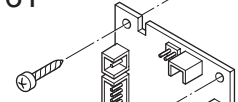
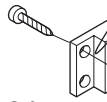
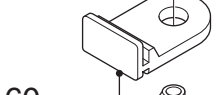
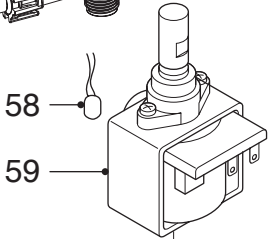
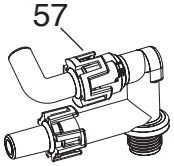
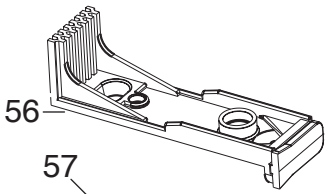
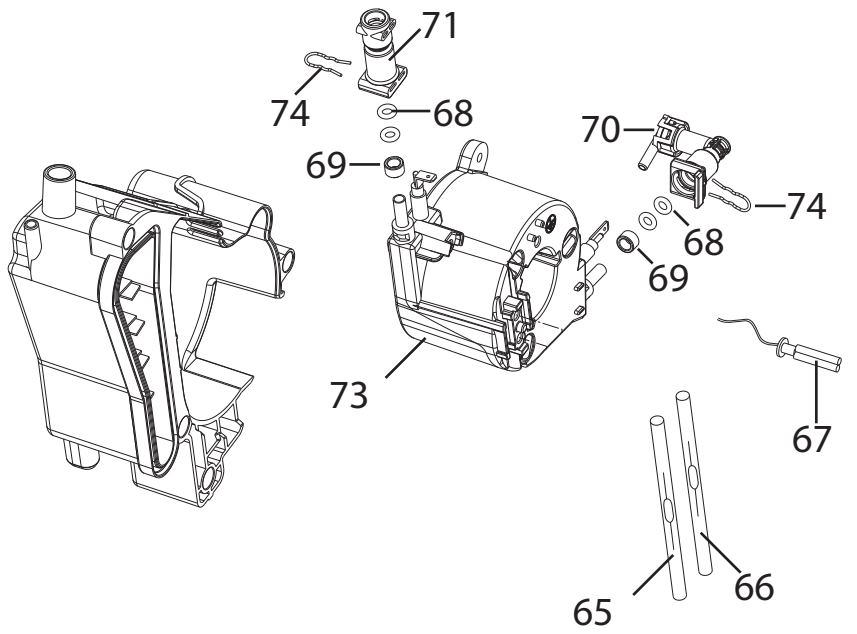

100

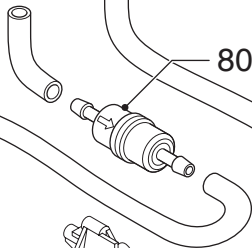

80

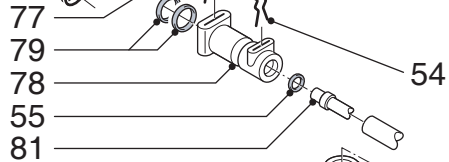

77
79
78
55
81

54

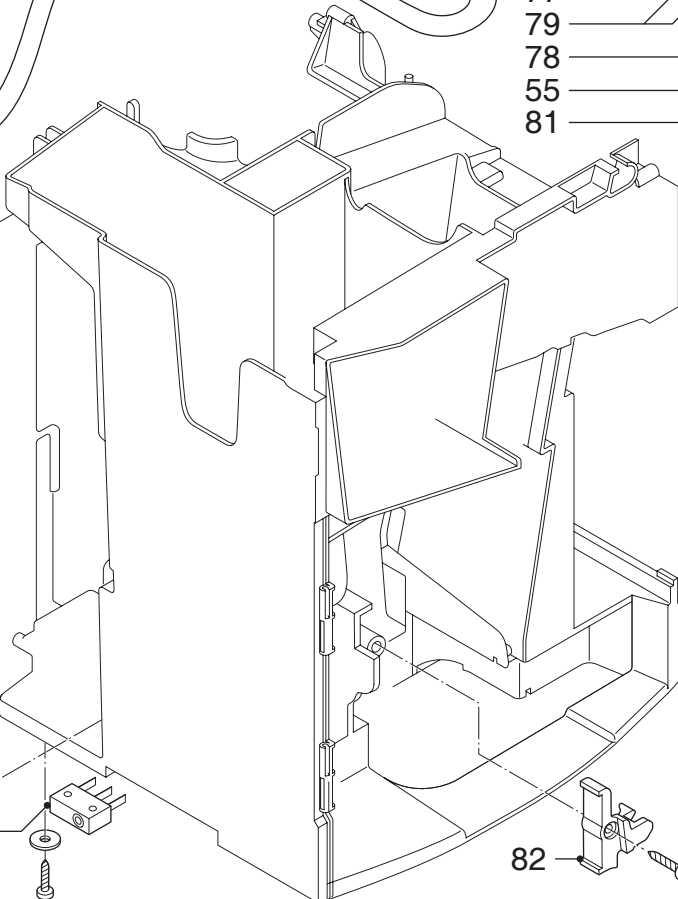

55

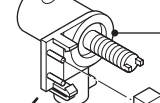

93

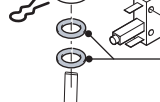

88

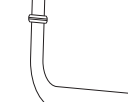

83

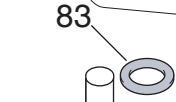

84



89

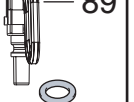

90

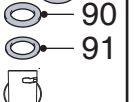

91

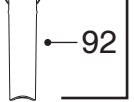

92

87



82

DE'LONGHI INT/A/RU/SKA/EST/TR ESAM3000.B EX:1 0132212097

Pos.	Spare part code	Description
001	5332143500	COVER
002	5332143400	COVER
004	5332262800	CLOSURE
005	5332143900	SIDE LEFT
006	5913210471	KNOB
007	5532146600	TANK
008	5313218991	REAR PANEL
009	5332143800	SIDE RIGHT
010	5213212291	BOARD
011	5332274500	TRAY
012	7332179300	DOOR ASSY
013	5332142600	HOOK
014	5332145600	COVER
015	7332165800	TANK
016	5332153300	PROFILE
017	6032105000	CUP PLATE
018	5332144200	TRAY
019	5332225000	BOTTOM
020	5332266300	FLOAT
023	5232110000	CONTROL BOARD 11 PIN
023	5213211631	CONTROL BOARD 8 PIN
027	7313215971	CONTROL PANEL
029	5532125700	KNOB
030	6032105300	DIFFUSER
031	5332149100	O-RING
032	7332222900	DIFFUSER KIT
034	7332203600	COMPLETE GRINDER
035	5332142200	SUPPORT

DE'LONGHI INT/A/RU/SKA/EST/TR ESAM3000.B EX:1 0132212097

Pos.	Spare part code	Description
036	6132104700	SPRING
037	5132105700	MICROSWITCH
038	7332166600	SLIDER
039	5332142400	BUSH
040	5332142300	BUSH
042	5313217751	O-RING
043	5332213000	PIN
044	5332148400	VALVE
045	6132106900	SPRING
046	5332144900	GASKET
047	5332139200	FILTER
048	5332110600	TUBE L=220
048	5332174600	TUBE DI=5 L=270
048	5332178100	TUBE DI=4 L=270
048	5332150700	TUBE L=55
049	5132103900	MICROSWITCH
050	5132110500	MICROSWITCH
051	5232110100	BOARD FEELER
052	5332170600	BELT
053	7313215791	TRANSMISSION KIT
054	6132101300	SPRING
055	5313217701	O-RING
056	5313216501	SUPPORT
057	7313217541	VALVE
058	5213211161	PROTECTOR
059	5132106900	PUMP
060	534848	SUPPORT
061	5232104600	SENSOR REED

DE'LONGHI INT/A/RU/SKA/EST/TR ESAM3000.B EX:1 0132212097

Pos.	Spare part code	Description
062	5213211641	POWER BOARD
063	5132105400	MICROSWITCH
064	5532151200	TUBE L=180
065	5013251401	WIRING TCO
066	5013251931	WIRING TCO
067	5217100200	SENSOR NTC
068	5313217691	O-RING
069	5332239300	SPACER
070	5313218931	CONNECTION
071	5332239200	CONNECTION
072	5313217701	O-RING
073	5513212471	GENERATOR
074	6113210021	SPRING
075	7313217261	ASSY MOTOR (MOTION) + PULLEY SMALL 230V (SERVICE) ATTENTION CHECK TECH
077	6113210021	SPRING
078	5332239200	CONNECTION
079	5313217691	O-RING
080	vt205651	FILTER
082	5332142600	HOOK
083	5332144700	O-RING
084	5332113800	TUBE LOWER
085	7313217501	INFUSOR
087	7313216621	TAP
088	5332144800	O-RING
089	5513213371	TUBE LOWER
090	5332257300	O-RING
091	535693	GASKET
092	5332229600	COVER

DE'LONGHI INT/A/RU/SKA/EST/TR ESAM3000.B EX:1 0132212097

Pos.	Spare part code	Description
093	5132103900	MICROSWITCH
094	5332139800	LEVER
095	6132103500	SPRING
096	9812631250	SCREW
097	5332139600	STOPPER
098	5332139500	VALVE
099	6132112200	SPRING
100	9824800014	CLIP CLAMP

Spare parts list extract from the site on 01-03-2010